

Pressure cell	Silicon, piezoresistiv with oil and welded stainless steel membrane
Pressure ranges	-200 bis +200 mbar differential pressure -350 bis +350 mbar differential pressure -500 bis +500 mbar differential pressure -700 bis +700 mbar differential pressure -1000 bis +1000 mbar differential pressure -1000 bis +2000 mbar differential pressure
Over pressure + side (HP)	max 2 bar / 3,5 bar for range -1000/+2000 mbar
Over pressure - side (LP)	max 1 bar
System pressure	0 to + 3,5 bar gauge
Medium + side (HP)	compatible with stainless steel 1.4301, 1.4401
Medium - side (LP)	clean, dry, non-corrosive gas
Working temperature	-40 to + 125 °C
Total accuracy -20/+85 °C	< ±1% FS
Total accuracy -40/+125 °C	< ±2% FS / < ±2,5% for range -200/+200 mbar
Offset Zero-/ Endpoint	typ. < ±15 mV @ 25 °C
Longterm stability	typ. < ± 0,1% FS / year
Analogue signal	0,5 to 4,5 VDC, ratiometric
Power supply	5 VDC
Overvoltage protection	± 30 VDC
Electrical Connection	1 m Draka-cable
Mech. Connection + side	Female M8*1 thread with inner cone 115° ± 2°
- side	Tube connector
Diameter	19 mm
Hex	SW 19
Documentation	Data of final test as Excel-file

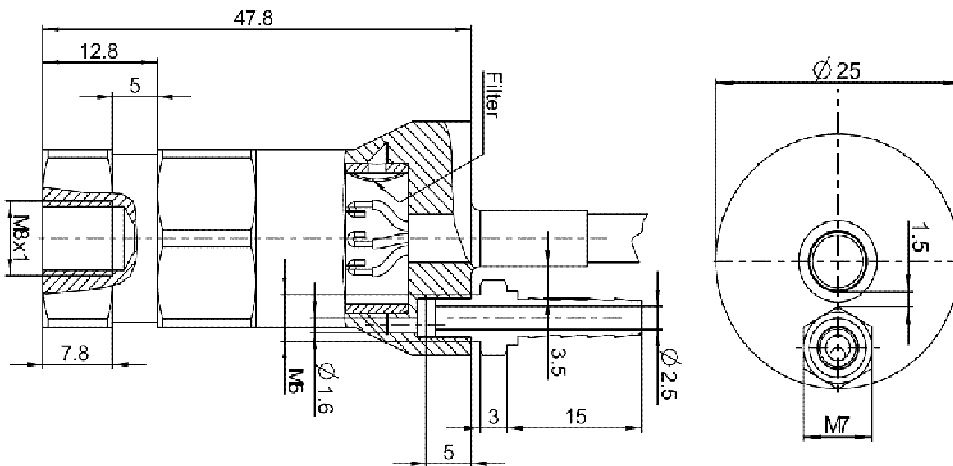

Version 06-2014 ◊ subject to alteration



PMT GmbH ◊ Bürgermeister-Kiefer-Str. 32 ◊ 84072 Au Hallertau
Tel. 08752 865961 ◊ Fax. 08752 865963 ◊ info@pmt-au.de ◊ www.pmt-au.de